

THIS MAP WAS PREPARED FOR ASSESSMENT PURPOSE ONLY

SW1/4 NE1/4 SEC. 35 T.2N. R.1W. W.M.
MULTNOMAH COUNTY

1" = 100'

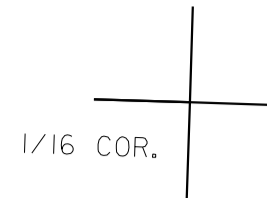

2N 1W 35AC
PORTLAND



SEE MAP 2N 1W 35B

SEE MAP 2N 1W 35CB

SEE MAP 2N 1W 35A

SEE MAP 2N 1W 35D

2N 1W 35AC
PORTLAND